



MIRARO

Standard Castors

A standard castor comes with various choices of mounting parts, wheel selections and braking methods making it a highly versatile component for your mobile institutional equipments.

For more appealing appearance, there is also a choice of bright chrome plating over zinc-chromatized plating finish. Anti-static wheels are much preferred by the electronic industry and, wherever ESD poses a major concern to the manufacturing or assembly process.

Application:

Mobile transport equipments used in electronic industry; general trolleys/carts in airports; and other general institutional applications.

Size Available:

75x25, 100x25, 125x25, 75x32, 100x32, 125x32, 150x32, 200x32mm

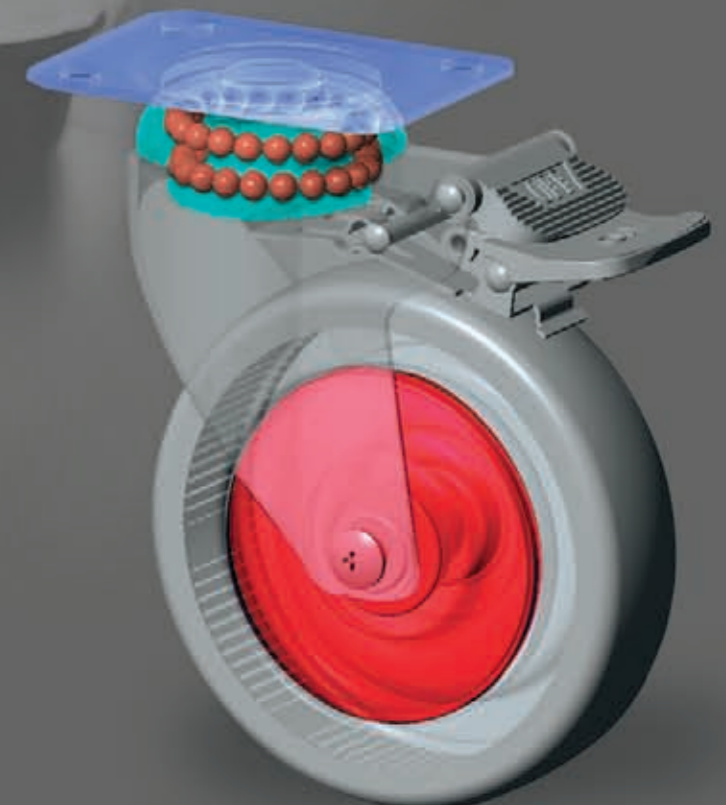
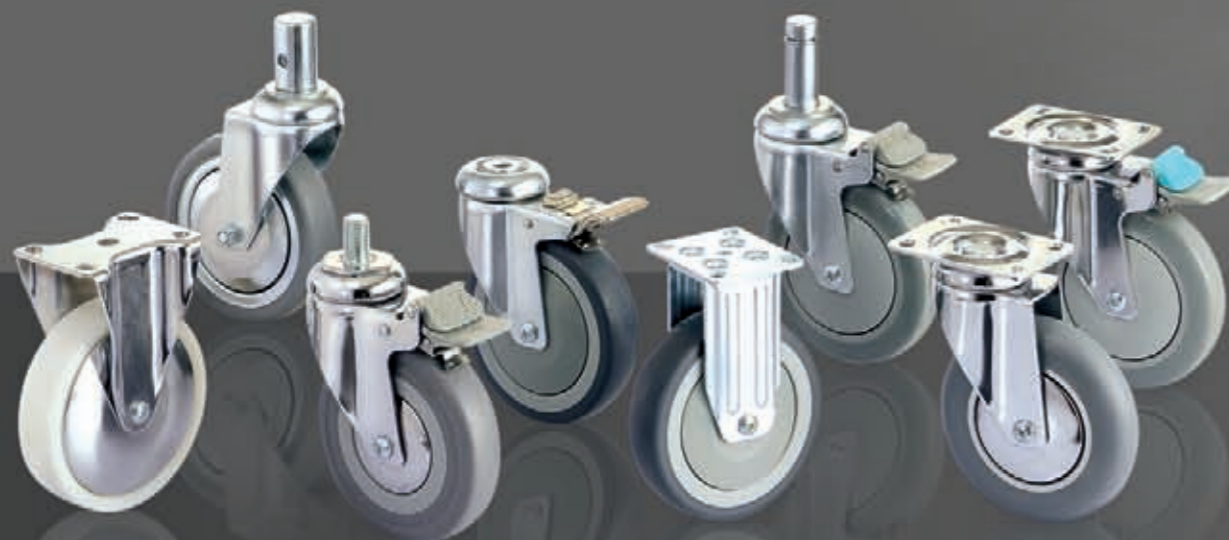

MIRARO

Standard Castors

Pressed steel, double ballrace swivel yoke, zinc-chromatized finish

Option: Bright chrome plated finish is also available, add suffix "-CR" to Catis code, e.g. Y580XP1/W503U-CR



TB/A Total locking brake

Total Lock system locks both swivel head and wheel simultaneously for secure parking. Integrated ON/OFF Nylon brake pedals for easy and quiet operation.



DB/A Directional locking brake

Directional Lock permits free wheel rotation while swivel head remains locked, an easy way to keep equipment traveling straight. Integrated ON/OFF Nylon brake pedals for easy and quiet operation. Release pedal in green color.

P Top Plate Fitting

PRB Wheel Plastic hub, grey color elastic rubber tire

Brake type	mm	mm		mm	mm	mm	mm	mm	mm	kg	Code
TB/A Total locking brake	75	32		95 x 70	75 x 52 / 72 x 45	9.0	33.0	107.0	50		Y380XP1/W324
	75	32		77 x 67	61.5 x 52 / 56 x 45	8.5	33.0	107.0	50		Y380XP2/W324
	100	32		95 x 70	75 x 52 / 72 x 45	9.0	40.5	135.0	80		Y480XP1/W424
	100	32		77 x 67	61.5 x 52 / 56 x 45	8.5	40.5	135.0	80		Y480XP2/W424
	125	32		95 x 70	75 x 52 / 72 x 45	9.0	39.0	161.0	100		Y580XP1/W524
	125	32		77 x 67	61.5 x 52 / 56 x 45	8.5	39.0	161.0	100		Y580XP2/W524
	150	32		95 x 70	75 x 52 / 72 x 45	9.0	50.0	189.5	100		Y680XP1/W624
	150	32		77 x 67	61.5 x 52 / 56 x 45	8.5	50.0	189.5	100		Y680XP2/W624
TB/B Total locking brake	75	32		95 x 70	75 x 52 / 72 x 45	9.0	41.0	107.0	50		Y380P1/W324
	75	32		77 x 67	61.5 x 52 / 56 x 45	8.5	41.0	107.0	50		Y380P2/W324
	100	32		95 x 70	75 x 52 / 72 x 45	9.0	40.5	135.0	80		Y480P1/W424
	100	32		77 x 67	61.5 x 52 / 56 x 45	8.5	40.5	135.0	80		Y480P2/W424
	125	32		95 x 70	75 x 52 / 72 x 45	9.0	39.0	161.0	100		Y580P1/W524
	125	32		77 x 67	61.5 x 52 / 56 x 45	8.5	39.0	161.0	100		Y580P2/W524
	150	32		95 x 70	75 x 52 / 72 x 45	9.0	46.5	189.5	100		Y680P1/W624
	150	32		77 x 67	61.5 x 52 / 56 x 45	8.5	46.5	189.5	100		Y680P2/W624





TB/BS Total locking brake
 Total Lock system simultaneously locks both swivel head and wheel for a secure parking.
 Zinc-alloy brake pedal.

P Top Plate Fitting

PRB Wheel Plastic hub, grey color elastic rubber tire

Brake type	mm	mm	mm	mm	mm	mm	mm	mm	kg	Code
DB/4 Dir. locking brake	100	32		95 x 70	75 x 52 / 72 x 45	9.0	40.5	135.0	80	Y480XDP1/W424
	100	32		77 x 67	61.5 x 52 / 56 x 45	8.5	40.5	135.0	80	Y480XDP2/W424
	125	32		95 x 70	75 x 52 / 72 x 45	9.0	39.0	161.0	100	Y580XDP1/W524
	125	32		77 x 67	61.5 x 52 / 56 x 45	8.5	39.0	161.0	100	Y580XDP2/W524
	150	32		95 x 70	75 x 52 / 72 x 45	9.0	50.0	189.5	100	Y680XDP1/W624
	150	32		77 x 67	61.5 x 52 / 56 x 45	8.5	50.0	189.5	100	Y680XDP2/W624
Non-brake Free swivel	75	32		95 x 70	75 x 52 / 72 x 45	9.0	33.0	107.0	50	Y381P1/W324
	75	32		77 x 67	61.5 x 52 / 56 x 45	8.5	33.0	107.0	50	Y381P2/W324
	75	32		105 x 80	85 x 60 / 75 x 60	10.0	33.0	107.0	50	Y381P3/W324
	100	32		95 x 70	75 x 52 / 72 x 45	9.0	40.5	135.0	80	Y481P1/W424
	100	32		77 x 67	61.5 x 52 / 56 x 45	8.5	40.5	135.0	80	Y481P2/W424
	100	32		105 x 80	85 x 60 / 75 x 60	10.0	40.5	135.0	80	Y481P3/W424
	125	32		95 x 70	75 x 52 / 72 x 45	9.0	39.0	161.0	100	Y581P1/W524
	125	32		77 x 67	61.5 x 52 / 56 x 45	8.5	39.0	161.0	100	Y581P2/W524
	125	32		105 x 80	85 x 60 / 75 x 60	10.0	39.0	161.0	100	Y581P3/W524
	150	32		95 x 70	75 x 52 / 72 x 45	9.0	50.0	189.5	100	Y681P1/W624
	150	32		77 x 67	61.5 x 52 / 56 x 45	8.5	50.0	189.5	100	Y681P2/W624
	150	32		105 x 80	85 x 60 / 75 x 60	10.0	50.0	189.5	100	Y681P3/W624

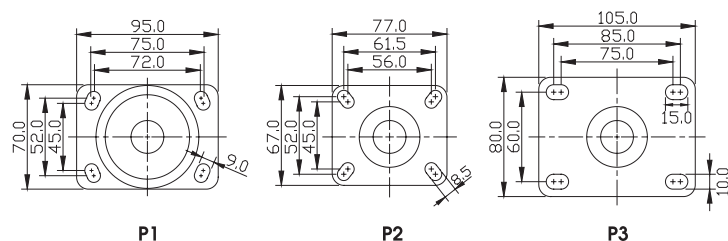

MIRARO

Standard Castors

Pressed steel, double ballrace swivel yoke, zinc-chromatized finish

Option: Bright chrome plated finish is also available, add suffix "-CR" to Catis code, e.g. Y580XP1/W503U-CR



TB Total locking brake

Total Lock system locks both swivel head and wheel simultaneously for secure parking. Integrated ON/OFF Nylon brake pedals for easy and quiet operation.



DB Directional locking brake

Directional Lock permits free wheel rotation while swivel head remains locked, an easy way to keep equipment traveling straight. Integrated ON/OFF Nylon brake pedals for easy and quiet operation. Release pedal in green color.

P Top Plate Fitting



PRB Wheel Plastic hub, grey color elastic rubber tire

Brake type	mm	mm	mm	mm	mm	mm	mm	kg	Code	
Non-brake Fixed	75	32		95 x 77	75 x 52 / 72 x 45	9.0	107.0	50	Y382P1/W324	
	100	32		95 x 77	75 x 52 / 72 x 45	9.0	135.0	80	Y482P1/W424	
	125	32		95 x 77	75 x 52 / 72 x 45	9.0	161.0	100	Y582P1/W524	
	150	32		95 x 77	75 x 52 / 72 x 45	9.0	189.5	100	Y682P1/W624	
	75	32		67 x 77	52 x 61.5 / 45 x 56	8.5	107.0	50	Y385P2/W324	
	100	32		67 x 77	52 x 61.5 / 45 x 56	8.5	135.0	80	Y485P2/W424	
	125	32		67 x 77	52 x 61.5 / 45 x 56	8.5	161.0	100	Y585P2/W524	
	100	32		105 x 80	85 x 60 / 75 x 60	10.0	135.0	80	Y448P3/W424	
	125	32		105 x 80	85 x 60 / 75 x 60	10.0	161.0	100	Y548P3/W524	

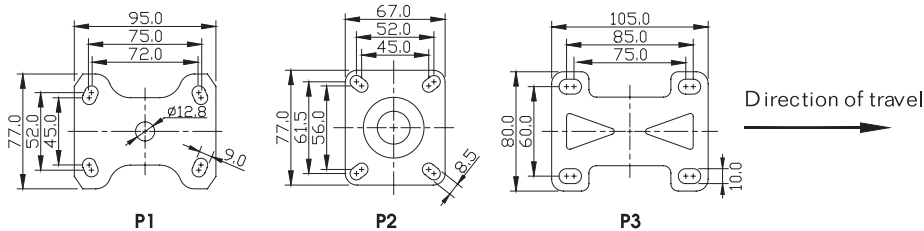



TB/β Total locking brake
 Total Lock system simultaneously locks both swivel head and wheel for a secure parking.
 Zinc-alloy brake pedal.

P Top Plate Fitting

SRB Wheel **SRB** Wheel Pressed steel hub, grey color elastic rubber tire

Brake type	mm	mm	mm	mm	mm	mm	mm	mm	kg	Code
TB/β Total locking brake	100	32		95 x 70	75 x 52 / 72 x 45	9.0	40.5	135.0	80	Y480XP1/W423
	100	32		77 x 67	61.5 x 52 / 56 x 45	8.5	40.5	135.0	80	Y480XP2/W423
	125	32		95 x 70	75 x 52 / 72 x 45	9.0	39.0	161.0	100	Y580XP1/W523
	125	32		77 x 67	61.5 x 52 / 56 x 45	8.5	39.0	161.0	100	Y580XP2/W523
	150	32		95 x 70	75 x 52 / 72 x 45	9.0	50.0	189.5	100	Y680XP1/W623
	150	32		77 x 67	61.5 x 52 / 56 x 45	8.5	50.0	189.5	100	Y680XP2/W623
TB/β Total locking brake	100	32		95 x 70	75 x 52 / 72 x 45	9.0	40.5	135.0	80	Y480P1/W423
	100	32		77 x 67	61.5 x 52 / 56 x 45	8.5	40.5	135.0	80	Y480P2/W423
	125	32		95 x 70	75 x 52 / 72 x 45	9.0	39.0	161.0	100	Y580P1/W523
	125	32		77 x 67	61.5 x 52 / 56 x 45	8.5	39.0	161.0	100	Y580P2/W523
	150	32		95 x 70	75 x 52 / 72 x 45	9.0	46.5	189.5	100	Y680P1/W623
	150	32		77 x 67	61.5 x 52 / 56 x 45	8.5	46.5	189.5	100	Y680P2/W623
DB/α Dir. locking brake	100	32		95 x 70	75 x 52 / 72 x 45	9.0	40.5	135.0	80	Y480XDP1/W423
	100	32		77 x 67	61.5 x 52 / 56 x 45	8.5	40.5	135.0	80	Y480XDP2/W423
	125	32		95 x 70	75 x 52 / 72 x 45	9.0	39.0	161.0	100	Y580XDP1/W523
	125	32		77 x 67	61.5 x 52 / 56 x 45	8.5	39.0	161.0	100	Y580XDP2/W523
	150	32		95 x 70	75 x 52 / 72 x 45	9.0	50.0	189.5	100	Y680XDP1/W623
	150	32		77 x 67	61.5 x 52 / 56 x 45	8.5	50.0	189.5	100	Y680XDP2/W623

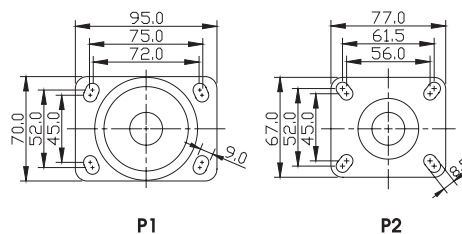

MIRARO

Standard Castors

Pressed steel, double ballrace swivel yoke, zinc-chromatized finish

Option: Bright chrome plated finish is also available, add suffix "-CR" to Catis code, e.g. Y580XP1/W503U-CR



TB Total locking brake
Total Lock system locks both swivel head and wheel simultaneously for secure parking. Integrated ON/OFF Nylon brake pedals for easy and quiet operation.



DB Directional locking brake
Directional Lock permits free wheel rotation while swivel head remains locked, an easy way to keep equipment traveling straight. Integrated ON/OFF Nylon brake pedals for easy and quiet operation. Release pedal in green color.

P Top Plate Fitting

SRB Wheel Pressed steel hub, grey color elastic rubber tire

Brake type	mm	mm	mm	mm	mm	mm	mm	mm	kg	Code
Non-brake Free swivel	100	32		95 x 70	75 x 52 / 72 x 45	9.0	40.5	135.0	80	Y481P1/W423
	100	32		77 x 67	61.5 x 52 / 56 x 45	8.5	40.5	135.0	80	Y481P2/W423
	100	32		105 x 80	85 x 60 / 75 x 60	10.0	40.5	135.0	80	Y481P3/W423
	125	32		95 x 70	75 x 52 / 72 x 45	9.0	39.0	161.0	100	Y581P1/W523
	125	32		77 x 67	61.5 x 52 / 56 x 45	8.5	39.0	161.0	100	Y581P2/W523
	125	32		105 x 80	85 x 60 / 75 x 60	10.0	39.0	161.0	100	Y581P3/W523
	150	32		95 x 70	75 x 52 / 72 x 45	9.0	50.0	189.5	100	Y681P1/W623
	150	32		77 x 67	61.5 x 52 / 56 x 45	8.5	50.0	189.5	100	Y681P2/W623
	150	32		105 x 80	85 x 60 / 75 x 60	10.0	50.0	189.5	100	Y681P3/W623

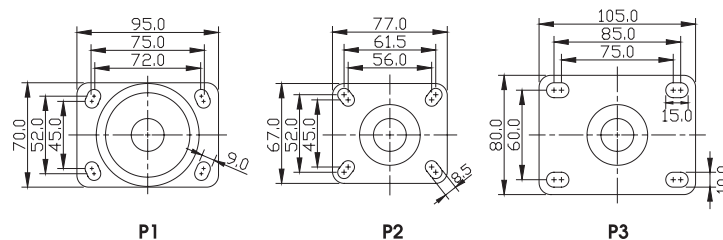



TB Total locking brake
 Total Lock system simultaneously locks both swivel head and wheel for a secure parking.
 Zinc-alloy brake pedal.

P Top Plate Fitting

SRB Wheel Pressed steel hub, grey color elastic rubber tire

Brake type	mm	mm		mm	mm	mm	mm	kg	Code	
Non-brake Fixed	100	32		95 x 77	75 x 52 / 72 x 45	9.0	135.0	80	Y482P1/W423	
	125	32		95 x 77	75 x 52 / 72 x 45	9.0	161.0	100	Y582P1/W523	
	150	32		95 x 77	75 x 52 / 72 x 45	9.0	189.5	100	Y682P1/W623	
	100	32		67 x 77	52 x 61.5 / 45 x 56	8.5	135.0	80	Y485P2/W423	
	125	32		67 x 77	52 x 61.5 / 45 x 56	8.5	161.0	100	Y585P2/W523	
	100	32		105 x 80	85 x 60 / 75 x 60	10.0	135.0	80	Y448P3/W423	
	125	32		105 x 80	85 x 60 / 75 x 60	10.0	161.0	100	Y548P3/W523	

SRB/BKAS Wheel Conductive wheels are also available

	Code	
Pressed steel hub and threadguards, zinc-chromatized finish, black color conductive rubber tire	100 x 32mm W423-BKAS	
Add suffix "-CR" to Catis code for bright chrome finish	125 x 32mm W523-BKAS	
	150 x 32mm W623-BKAS	

Electrical Resistance $\leq 10^4 \Omega$

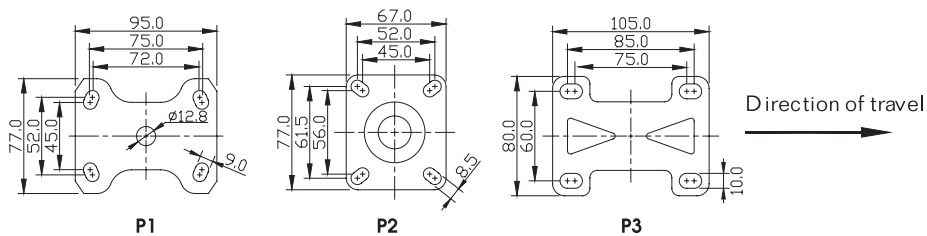

MIRARO

Standard Castors

Pressed steel, double ballrace swivel yoke, zinc-chromatized finish

Option: Bright chrome plated finish is also available, add suffix "-CR" to Catis code, e.g. Y580XP1/W503U-CR



TB/A Total locking brake

Total Lock system locks both swivel head and wheel simultaneously for secure parking. Integrated ON/OFF Nylon brake pedals for easy and quiet operation.



DB/A Directional locking brake

Directional Lock permits free wheel rotation while swivel head remains locked, an easy way to keep equipment traveling straight. Integrated ON/OFF Nylon brake pedals for easy and quiet operation. Release pedal in green color.

P Top Plate Fitting

TPR Wheel Plastic hub, grey color thermoplastic rubber tire

Brake type	mm	mm	mm	mm	mm	mm	mm	mm	kg	Code
TB/A Total locking brake	75	25		77 x 67	61.5 x 52 / 56 x 45	8.5	30.0	107.0	45	Y360P2/W312
	100	25		77 x 67	61.5 x 52 / 56 x 45	8.5	38.5	135.0	60	Y460P2/W412
	125	25		95 x 70	75 x 52 / 72 x 45	9.0	38.5	161.0	70	Y560P1/W512
	125	25		77 x 67	61.5 x 52 / 56 x 45	8.5	38.5	161.0	70	Y560P2/W512
	100	32		95 x 70	75 x 52 / 72 x 45	9.0	40.5	135.0	80	Y480XP1/W403
	100	32		77 x 67	61.5 x 52 / 56 x 45	8.5	40.5	135.0	80	Y480XP2/W403
	125	32		95 x 70	75 x 52 / 72 x 45	9.0	39.0	161.0	100	Y580XP1/W503
	125	32		77 x 67	61.5 x 52 / 56 x 45	8.5	39.0	161.0	100	Y580XP2/W503
	125	32		95 x 70	75 x 52 / 72 x 45	9.0	39.0	161.0	100	Y580XP1/W503U
	125	32		77 x 67	61.5 x 52 / 56 x 45	8.5	39.0	161.0	100	Y580XP2/W503U
TB/B Total locking brake	150	32		95 x 70	75 x 52 / 72 x 45	9.0	50.0	189.5	100	Y680XP1/W603U
	150	32		77 x 67	61.5 x 52 / 56 x 45	8.5	50.0	189.5	100	Y680XP2/W603U
	100	32		95 x 70	75 x 52 / 72 x 45	9.0	40.5	135.0	80	Y480P1/W403
	100	32		77 x 67	61.5 x 52 / 56 x 45	8.5	40.5	135.0	80	Y480P2/W403
	125	32		95 x 70	75 x 52 / 72 x 45	9.0	39.0	161.0	100	Y580P1/W503
	125	32		77 x 67	61.5 x 52 / 56 x 45	8.5	39.0	161.0	100	Y580P2/W503
	125	32		95 x 70	75 x 52 / 72 x 45	9.0	39.0	161.0	100	Y580P1/W503U
	125	32		77 x 67	61.5 x 52 / 56 x 45	8.5	39.0	161.0	100	Y580P2/W503U

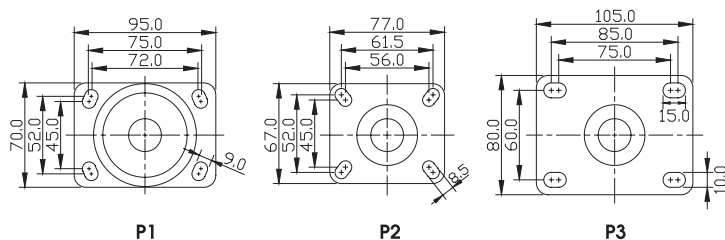



TB/BS Total locking brake
 Total Lock system simultaneously locks both swivel head and wheel for a secure parking.
 Zinc-alloy brake pedal.

P Top Plate Fitting



TPR Wheel Plastic hub, grey color thermoplastic rubber tire

Brake type	mm	mm	mm	mm	mm	mm	mm	mm	kg	Code
DB/ Dir. locking brake	100	32		95 x 70	75 x 52 / 72 x 45	9.0	40.5	135.0	80	Y480XDP1/W403
	100	32		77 x 67	61.5 x 52 / 56 x 45	8.5	40.5	135.0	80	Y480XDP2/W403
	125	32		95 x 70	75 x 52 / 72 x 45	9.0	39.0	161.0	100	Y580XDP1/W503
	125	32		77 x 67	61.5 x 52 / 56 x 45	8.5	39.0	161.0	100	Y580XDP2/W503
	125	32		95 x 70	75 x 52 / 72 x 45	9.0	39.0	161.0	100	Y580XDP1/W503U
	125	32		77 x 67	61.5 x 52 / 56 x 45	8.5	39.0	161.0	100	Y580XDP2/W503U
	150	32		95 x 70	75 x 52 / 72 x 45	9.0	50.0	189.5	100	Y680XDP1/W603U
	150	32		77 x 67	61.5 x 52 / 56 x 45	8.5	50.0	189.5	100	Y680XDP2/W603U
Non-brake Free swivel	75	25		95 x 70	75 x 52 / 72 x 45	9.0	30.0	107.0	45	Y361P1/W312
	75	25		77 x 67	61.5 x 52 / 56 x 45	8.5	30.0	107.0	45	Y361P2/W312
	100	25		95 x 70	75 x 52 / 72 x 45	9.0	38.5	135.0	60	Y461P1/W412
	100	25		77 x 67	61.5 x 52 / 56 x 45	8.5	38.5	135.0	60	Y461P2/W412
	125	25		95 x 70	75 x 52 / 72 x 45	9.0	38.5	161.0	70	Y561P1/W512
	125	25		77 x 67	61.5 x 52 / 56 x 45	8.5	38.5	161.0	70	Y561P2/W512
	100	32		95 x 70	75 x 52 / 72 x 45	9.0	40.5	135.0	80	Y481P1/W403
	100	32		77 x 67	61.5 x 52 / 56 x 45	8.5	40.5	135.0	80	Y481P2/W403
	100	32		105 x 80	85 x 60 / 75 x 60	10.0	40.5	135.0	80	Y481P3/W403
	125	32		95 x 70	75 x 52 / 72 x 45	9.0	39.0	161.0	100	Y581P1/W503
	125	32		77 x 67	61.5 x 52 / 56 x 45	8.5	39.0	161.0	100	Y581P2/W503
	125	32		105 x 80	85 x 60 / 75 x 60	10.0	39.0	161.0	100	Y581P3/W503
	125	32		95 x 70	75 x 52 / 72 x 45	9.0	39.0	161.0	100	Y581P1/W503U
	125	32		77 x 67	61.5 x 52 / 56 x 45	8.5	39.0	161.0	100	Y581P2/W503U
	125	32		105 x 80	85 x 60 / 75 x 60	10.0	39.0	161.0	100	Y581P3/W503U
	150	32		95 x 70	75 x 52 / 72 x 45	9.0	50.0	189.5	100	Y681P1/W603U
	150	32		77 x 67	61.5 x 52 / 56 x 45	8.5	50.0	189.5	100	Y681P2/W603U
	150	32		105 x 80	85 x 60 / 75 x 60	10.0	50.0	189.5	100	Y681P3/W603U



MIRARO

Standard Castors

Pressed steel, double ballrace swivel yoke, zinc-chromatized finish

Option: Bright chrome plated finish is also available, add suffix "-CR" to Catis code, e.g. Y580XP1/W503U-CR



TB Total locking brake

Total Lock system locks both swivel head and wheel simultaneously for secure parking. Integrated ON/OFF Nylon brake pedals for easy and quiet operation.



DB Directional locking brake

Directional Lock permits free wheel rotation while swivel head remains locked, an easy way to keep equipment traveling straight. Integrated ON/OFF Nylon brake pedals for easy and quiet operation. Release pedal in green color.

P Top Plate Fitting



TPR Wheel

Plastic hub, grey color thermoplastic rubber tire

Brake type	mm	mm		mm	mm	mm	mm	kg	Code	
Non-brake Fixed	100	32		95 x 77	75 x 52 / 72 x 45	9.0	135.0	80	Y482P1/W403	
	125	32		95 x 77	75 x 52 / 72 x 45	9.0	161.0	100	Y582P1/W503	
	125	32		95 x 77	75 x 52 / 72 x 45	9.0	161.0	100	Y582P1/W503U	
	150	32		95 x 77	75 x 52 / 72 x 45	9.0	189.5	100	Y682P1/W603U	
	100	32		67 x 77	52 x 61.5 / 45 x 56	8.5	135.0	80	Y485P2/W403	
	125	32		67 x 77	52 x 61.5 / 45 x 56	8.5	161.0	100	Y585P2/W503	
	125	32		67 x 77	52 x 61.5 / 45 x 56	8.5	161.0	100	Y585P2/W503U	
	100	32		105 x 80	85 x 60 / 75 x 60	10.0	135.0	80	Y448P3/W403	
	125	32		105 x 80	85 x 60 / 75 x 60	10.0	161.0	100	Y548P3/W503	
	125	32		105 x 80	85 x 60 / 75 x 60	10.0	161.0	100	Y548P3/W503U	



TPR/AS Wheel

Conductive wheels are also available

		Code	
Plastic hub and threadguards, grey color conductive thermoplastic rubber tire	075 x 25mm	W303CX-AS*	
	100 x 32mm	W403-AS	
	125 x 32mm	W503-AS	
	150 x 32mm	W603U-AS	

*Wheel with metal threadguards (see P020)

Electrical Resistance $\leq 10^4 \Omega$

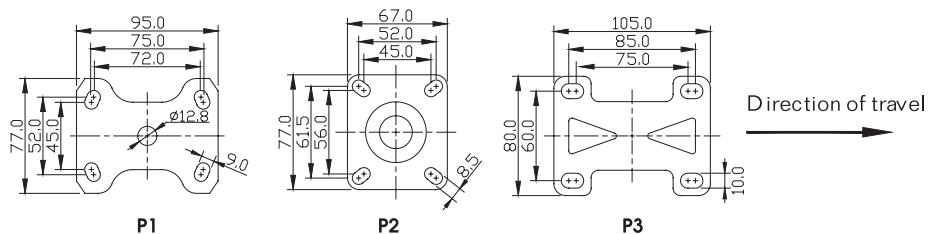



TB/B Total locking brake
 Total Lock system simultaneously locks both swivel head and wheel for a secure parking.
 Zinc-alloy brake pedal.

P Top Plate Fitting

TPU Wheel Plastic hub, grey color polyurethane tire

Brake type	mm	mm		mm	mm	mm	mm	mm	kg	Code
TB/B Total locking brake	75	32		95 x 70	75 x 52 / 72 x 45	9.0	33.0	107.0	50	Y380XP1/W300
	75	32		77 x 67	61.5 x 52 / 56 x 45	8.5	33.0	107.0	50	Y380XP2/W300
	100	32		95 x 70	75 x 52 / 72 x 45	9.0	40.5	135.0	80	Y480XP1/W400E
	100	32		77 x 67	61.5 x 52 / 56 x 45	8.5	40.5	135.0	80	Y480XP2/W400E
	125	32		95 x 70	75 x 52 / 72 x 45	9.0	39.0	161.0	100	Y580XP1/W500E
	125	32		77 x 67	61.5 x 52 / 56 x 45	8.5	39.0	161.0	100	Y580XP2/W500E
	150	32		95 x 70	75 x 52 / 72 x 45	9.0	50.0	189.5	100	Y680XP1/W600E
	150	32		77 x 67	61.5 x 52 / 56 x 45	8.5	50.0	189.5	100	Y680XP2/W600E
TB/B Total locking brake	75	32		95 x 70	75 x 52 / 72 x 45	9.0	41.0	107.0	50	Y380P1/W300
	75	32		77 x 67	61.5 x 52 / 56 x 45	8.5	41.0	107.0	50	Y380P2/W300
	100	32		95 x 70	75 x 52 / 72 x 45	9.0	40.5	135.0	80	Y480P1/W400E
	100	32		77 x 67	61.5 x 52 / 56 x 45	8.5	40.5	135.0	80	Y480P2/W400E
	125	32		95 x 70	75 x 52 / 72 x 45	9.0	39.0	161.0	100	Y580P1/W500E
	125	32		77 x 67	61.5 x 52 / 56 x 45	8.5	39.0	161.0	100	Y580P2/W500E
	150	32		95 x 70	75 x 52 / 72 x 45	9.0	46.5	189.5	100	Y680P1/W600E
	150	32		77 x 67	61.5 x 52 / 56 x 45	8.5	46.5	189.5	100	Y680P2/W600E

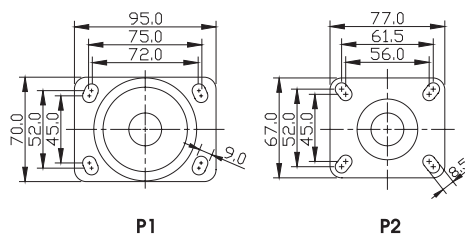

MIRARO

Standard Castors

Pressed steel, double ballrace swivel yoke, zinc-chromatized finish

Option: Bright chrome plated finish is also available, add suffix "-CR" to Catis code, e.g. Y580XP1/W503U-CR



TB Total locking brake

Total Lock system locks both swivel head and wheel simultaneously for secure parking. Integrated ON/OFF Nylon brake pedals for easy and quiet operation.



DB Directional locking brake

Directional Lock permits free wheel rotation while swivel head remains locked, an easy way to keep equipment traveling straight. Integrated ON/OFF Nylon brake pedals for easy and quiet operation. Release pedal in green color.

P Top Plate Fitting

TPU Wheel Plastic hub, grey color polyurethane tire

Brake type	mm	mm	mm	mm	mm	mm	mm	mm	kg	Code
DB Dir. locking brake	100	32		95 x 70	75 x 52 / 72 x 45	9.0	40.5	135.0	80	Y480XP1/W400E
	100	32		77 x 67	61.5 x 52 / 56 x 45	8.5	40.5	135.0	80	Y480XP2/W400E
	125	32		95 x 70	75 x 52 / 72 x 45	9.0	39.0	161.0	100	Y580XP1/W500E
	125	32		77 x 67	61.5 x 52 / 56 x 45	8.5	39.0	161.0	100	Y580XP2/W500E
	150	32		95 x 70	75 x 52 / 72 x 45	9.0	50.0	189.5	100	Y680XP1/W600E
	150	32		77 x 67	61.5 x 52 / 56 x 45	8.5	50.0	189.5	100	Y680XP2/W600E
Non-brake Free swivel	75	32		95 x 70	75 x 52 / 72 x 45	9.0	33.0	107.0	50	Y381P1/W300
	75	32		77 x 67	61.5 x 52 / 56 x 45	8.5	33.0	107.0	50	Y381P2/W300
	75	32		105 x 80	85 x 60 / 75 x 60	10.0	33.0	107.0	50	Y381P3/W300
	100	32		95 x 70	75 x 52 / 72 x 45	9.0	40.5	135.0	80	Y481P1/W400E
	100	32		77 x 67	61.5 x 52 / 56 x 45	8.5	40.5	135.0	80	Y481P2/W400E
	100	32		105 x 80	85 x 60 / 75 x 60	10.0	40.5	135.0	80	Y481P3/W400E
	125	32		95 x 70	75 x 52 / 72 x 45	9.0	39.0	161.0	100	Y581P1/W500E
	125	32		77 x 67	61.5 x 52 / 56 x 45	8.5	39.0	161.0	100	Y581P2/W500E
	125	32		105 x 80	85 x 60 / 75 x 60	10.0	39.0	161.0	100	Y581P3/W500E
	150	32		95 x 70	75 x 52 / 72 x 45	9.0	50.0	189.5	100	Y681P1/W600E
	150	32		77 x 67	61.5 x 52 / 56 x 45	8.5	50.0	189.5	100	Y681P2/W600E
	150	32		105 x 80	85 x 60 / 75 x 60	10.0	50.0	189.5	100	Y681P3/W600E

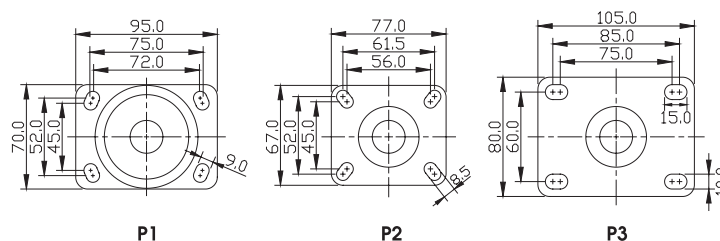



















TB Total locking brake
 Total Lock system simultaneously locks both swivel head and wheel for a secure parking.
 Zinc-alloy brake pedal.

P Top Plate Fitting

TPU Wheel Plastic hub, grey color polyurethane tire

Brake type	 mm	 mm		 mm	 mm	 mm	 mm	 kg	Code
Non-brake	75	32		95 x 77	75 x 52 / 72 x 45	9.0	107.0	50	Y382P1/W300
Fixed									
	100	32		95 x 77	75 x 52 / 72 x 45	9.0	135.0	80	Y482P1/W400E
	125	32		95 x 77	75 x 52 / 72 x 45	9.0	161.0	100	Y582P1/W500E
	150	32		95 x 77	75 x 52 / 72 x 45	9.0	189.5	100	Y682P1/W600E
	75	32		67 x 77	52 x 61.5 / 45 x 56	8.5	107.0	50	Y385P2/W300
	100	32		67 x 77	52 x 61.5 / 45 x 56	8.5	135.0	80	Y485P2/W400E
	125	32		67 x 77	52 x 61.5 / 45 x 56	8.5	161.0	100	Y585P2/W500E
	100	32		105 x 80	85 x 60 / 75 x 60	10.0	135.0	80	Y448P3/W400E
	125	32		105 x 80	85 x 60 / 75 x 60	10.0	161.0	100	Y548P3/W500E

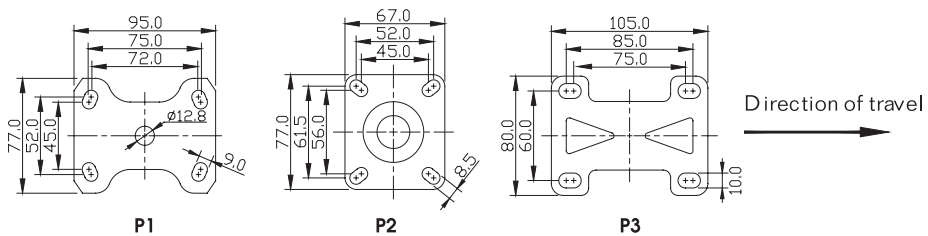

MIRARO

Standard Castors

Pressed steel, double ballrace swivel yoke, zinc-chromatized finish

Option: Bright chrome plated finish is also available, add suffix "-CR" to Catis code, e.g. Y580XP1/W503U-CR



TB/A Total locking brake

Total Lock system locks both swivel head and wheel simultaneously for secure parking. Integrated ON/OFF Nylon brake pedals for easy and quiet operation.



DB/A Directional locking brake

Directional Lock permits free wheel rotation while swivel head remains locked, an easy way to keep equipment traveling straight. Integrated ON/OFF Nylon brake pedals for easy and quiet operation. Release pedal in green color.

P Top Plate Fitting



ARB Wheel

Al-alloy hub, grey color high elastic rubber tire

Brake type	mm	mm		mm	mm	mm	mm	mm	mm	kg	Code
TB/A Total locking brake	125	32		95 x 70	75 x 52 / 72 x 45	9.0	39.0	161.0	100		Y580XP1/W529UX
	150	32		95 x 70	75 x 52 / 72 x 45	9.0	50.0	189.5	100		Y680XP1/W629UX
DB/A Dir. locking brake	125	32		95 x 70	75 x 52 / 72 x 45	9.0	39.0	161.0	100		Y580XDP1/W529UX
	150	32		95 x 70	75 x 52 / 72 x 45	9.0	50.0	189.5	100		Y680XDP1/W629UX
Non-brake Free swivel	125	32		95 x 70	75 x 52 / 72 x 45	9.0	39.0	161.0	100		Y581P1/W529UX
	150	32		95 x 70	75 x 52 / 72 x 45	9.0	50.0	189.5	100		Y681P1/W629UX





TB Total locking brake
 Total Lock system simultaneously locks both swivel head and wheel for a secure parking.
 Zinc-alloy brake pedal.

P Top Plate Fitting

PM Wheel Solid nylon wheel

Brake type	mm	mm	mm	mm	mm	mm	mm	mm	kg	Code
TB Total locking brake	75	32		95 x 70	75 x 52 / 72 x 45	9.0	33.0	107.0	50	Y380XP1/W309RX
	75	32		77 x 67	61.5 x 52 / 56 x 45	8.5	33.0	107.0	50	Y380XP2/W309RX
	100	32		95 x 70	75 x 52 / 72 x 45	9.0	40.5	135.0	80	Y480XP1/W409RX
	100	32		77 x 67	61.5 x 52 / 56 x 45	8.5	40.5	135.0	80	Y480XP2/W409RX
	125	32		95 x 70	75 x 52 / 72 x 45	9.0	39.0	161.0	100	Y580XP1/W509RX
	125	32		77 x 67	61.5 x 52 / 56 x 45	8.5	39.0	161.0	100	Y580XP2/W509RX
TB Total locking brake	75	32		95 x 70	75 x 52 / 72 x 45	9.0	41.0	107.0	50	Y380P1/W309RX
	75	32		77 x 67	61.5 x 52 / 56 x 45	8.5	41.0	107.0	50	Y380P2/W309RX
	100	32		95 x 70	75 x 52 / 72 x 45	9.0	40.5	135.0	80	Y480P1/W409RX
	100	32		77 x 67	61.5 x 52 / 56 x 45	8.5	40.5	135.0	80	Y480P2/W409RX
	125	32		95 x 70	75 x 52 / 72 x 45	9.0	39.0	161.0	100	Y580P1/W509RX
	125	32		77 x 67	61.5 x 52 / 56 x 45	8.5	39.0	161.0	100	Y580P2/W509RX

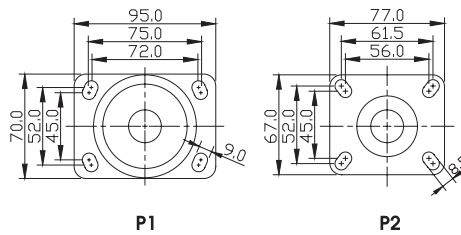

MIRARO

Standard Castors

Pressed steel, double ballrace swivel yoke, zinc-chromatized finish

Option: Bright chrome plated finish is also available, add suffix "-CR" to Catis code, e.g. Y580XP1/W503U-CR



TB Total locking brake

Total Lock system locks both swivel head and wheel simultaneously for secure parking. Integrated ON/OFF Nylon brake pedals for easy and quiet operation.



DB Directional locking brake

Directional Lock permits free wheel rotation while swivel head remains locked, an easy way to keep equipment traveling straight. Integrated ON/OFF Nylon brake pedals for easy and quiet operation. Release pedal in green color.

P Top Plate Fitting



PM Wheel Solid nylon wheel

Brake type	mm	mm	mm	mm	mm	mm	mm	mm	kg	Code
DB Dir. locking brake	100	32		95 x 70	75 x 52 / 72 x 45	9.0	40.5	135.0	80	Y480XDP1/W409RX
	100	32		77 x 67	61.5 x 52 / 56 x 45	8.5	40.5	135.0	80	Y480XDP2/W409RX
	125	32		95 x 70	75 x 52 / 72 x 45	9.0	39.0	161.0	100	Y580XDP1/W509RX
	125	32		77 x 67	61.5 x 52 / 56 x 45	8.5	39.0	161.0	100	Y580XDP2/W509RX
Non-brake Free swivel	75	32		95 x 70	75 x 52 / 72 x 45	9.0	33.0	107.0	50	Y381P1/W309RX
	75	32		77 x 67	61.5 x 52 / 56 x 45	8.5	33.0	107.0	50	Y381P2/W309RX
	75	32		105 x 80	85 x 60 / 75 x 60	10.0	33.0	107.0	50	Y381P3/W309RX
	100	32		95 x 70	75 x 52 / 72 x 45	9.0	40.5	135.0	80	Y481P1/W409RX
	100	32		77 x 67	61.5 x 52 / 56 x 45	8.5	40.5	135.0	80	Y481P2/W409RX
	100	32		105 x 80	85 x 60 / 75 x 60	10.0	40.5	135.0	80	Y481P3/W409RX
	125	32		95 x 70	75 x 52 / 72 x 45	9.0	39.0	161.0	100	Y581P1/W509RX
	125	32		77 x 67	61.5 x 52 / 56 x 45	8.5	39.0	161.0	100	Y581P2/W509RX
	125	32		105 x 80	85 x 60 / 75 x 60	10.0	39.0	161.0	100	Y581P3/W509RX

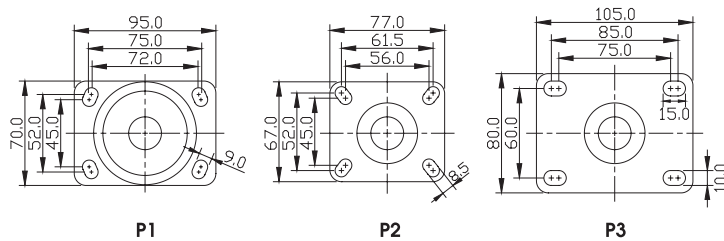

















TB Total locking brake

Total Lock system simultaneously locks both swivel head and wheel for a secure parking.
Zinc-alloy brake pedal.

P Top Plate Fitting

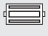
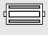
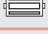
PM Wheel Solid nylon wheel

Brake type	 mm	 mm		 mm	 mm	 mm	 mm	 kg	Code
Non-brake Fixed	75	32		95 x 77	75 x 52 / 72 x 45	9.0	107.0	50	Y382P1/W309RX
	100	32		95 x 77	75 x 52 / 72 x 45	9.0	135.0	80	Y482P1/W409RX
	125	32		95 x 77	75 x 52 / 72 x 45	9.0	161.0	100	Y582P1/W509RX
	75	32		67 x 77	52 x 61.5 / 45 x 56	8.5	107.0	50	Y385P2/W309RX
	100	32		67 x 77	52 x 61.5 / 45 x 56	8.5	135.0	80	Y485P2/W409RX
	125	32		67 x 77	52 x 61.5 / 45 x 56	8.5	161.0	100	Y585P2/W509RX
	100	32		105 x 80	85 x 60 / 75 x 60	10.0	135.0	80	Y448P3/W409RX
	125	32		105 x 80	85 x 60 / 75 x 60	10.0	161.0	100	Y548P3/W509RX

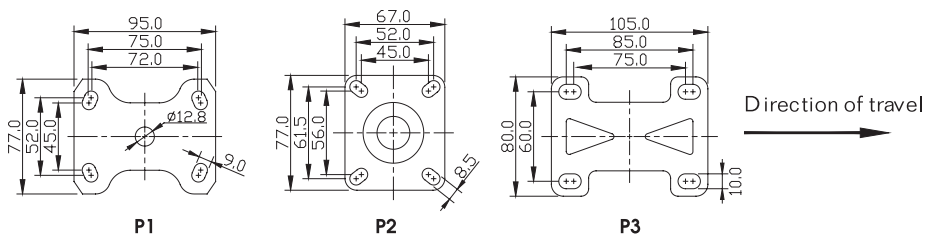

MIRARO

Standard Castors

Pressed steel, double ballrace swivel yoke, zinc-chromatized finish

Option: Bright chrome plated finish is also available, add suffix "-CR" to Catis code, e.g. Y580XP1/W503U-CR



TB/A Total locking brake

Total Lock system locks both swivel head and wheel simultaneously for secure parking. Integrated ON/OFF Nylon brake pedals for easy and quiet operation.



DB/A Directional locking brake

Directional Lock permits free wheel rotation while swivel head remains locked, an easy way to keep equipment traveling straight. Integrated ON/OFF Nylon brake pedals for easy and quiet operation. Release pedal in green color.

P Top Plate Fitting



PP Wheel

Solid polypropylene wheel

Brake type	mm	mm	mm	mm	mm	mm	mm	mm	kg	Code
TB/A Total locking brake	75	32		95 x 70	75 x 52 / 72 x 45	9.0	33.0	107.0	50	Y380XP1/W310RX
	75	32		77 x 67	61.5 x 52 / 56 x 45	8.5	33.0	107.0	50	Y380XP2/W310RX
	100	32		95 x 70	75 x 52 / 72 x 45	9.0	40.5	135.0	80	Y480XP1/W410RX
	100	32		77 x 67	61.5 x 52 / 56 x 45	8.5	40.5	135.0	80	Y480XP2/W410RX
	125	32		95 x 70	75 x 52 / 72 x 45	9.0	39.0	161.0	100	Y580XP1/W510RX
	125	32		77 x 67	61.5 x 52 / 56 x 45	8.5	39.0	161.0	100	Y580XP2/W510RX
TB/B Total locking brake	75	32		95 x 70	75 x 52 / 72 x 45	9.0	41.0	107.0	50	Y380P1/W310RX
	75	32		77 x 67	61.5 x 52 / 56 x 45	8.5	41.0	107.0	50	Y380P2/W310RX
	100	32		95 x 70	75 x 52 / 72 x 45	9.0	40.5	135.0	80	Y480P1/W410RX
	100	32		77 x 67	61.5 x 52 / 56 x 45	8.5	40.5	135.0	80	Y480P2/W410RX
	125	32		95 x 70	75 x 52 / 72 x 45	9.0	39.0	161.0	100	Y580P1/W510RX
	125	32		77 x 67	61.5 x 52 / 56 x 45	8.5	39.0	161.0	100	Y580P2/W510RX
DB/A Dir. locking brake	100	32		95 x 70	75 x 52 / 72 x 45	9.0	40.5	135.0	80	Y480XDP1/W410RX
	100	32		77 x 67	61.5 x 52 / 56 x 45	8.5	40.5	135.0	80	Y480XDP2/W410RX
	125	32		95 x 70	75 x 52 / 72 x 45	9.0	39.0	161.0	100	Y580XDP1/W510RX
	125	32		77 x 67	61.5 x 52 / 56 x 45	8.5	39.0	161.0	100	Y580XDP2/W510RX

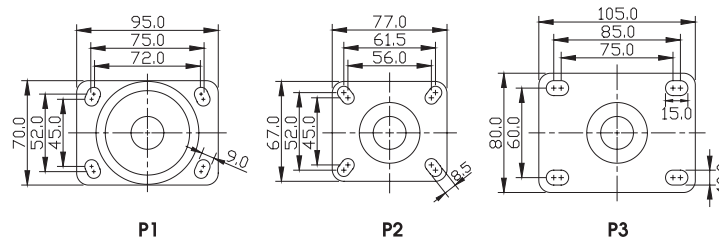



TB Total locking brake
 Total Lock system simultaneously locks both swivel head and wheel for a secure parking.
 Zinc-alloy brake pedal.

P Top Plate Fitting



PP Wheel Solid polypropylene wheel

Brake type	mm	mm	mm	mm	mm	mm	mm	kg	Code	
Non-brake Free swivel	75	32		95 x 70	75 x 52 / 72 x 45	9.0	33.0	107.0	50	Y381P1/W310RX
	75	32		77 x 67	61.5 x 52 / 56 x 45	8.5	33.0	107.0	50	Y381P2/W310RX
	75	32		105 x 80	85 x 60 / 75 x 60	10.0	33.0	107.0	50	Y381P3/W310RX
	100	32		95 x 70	75 x 52 / 72 x 45	9.0	40.5	135.0	80	Y481P1/W410RX
	100	32		77 x 67	61.5 x 52 / 56 x 45	8.5	40.5	135.0	80	Y481P2/W410RX
	100	32		105 x 80	85 x 60 / 75 x 60	10.0	40.5	135.0	80	Y481P3/W410RX
	125	32		95 x 70	75 x 52 / 72 x 45	9.0	39.0	161.0	100	Y581P1/W510RX
	125	32		77 x 67	61.5 x 52 / 56 x 45	8.5	39.0	161.0	100	Y581P2/W510RX
	125	32		105 x 80	85 x 60 / 75 x 60	10.0	39.0	161.0	100	Y581P3/W510RX



Brake type	mm	mm	mm	mm	mm	mm	mm	kg	Code
Non-brake Fixed	75	32		95 x 77	75 x 52 / 72 x 45	9.0	107.0	50	Y382P1/W310RX
	100	32		95 x 77	75 x 52 / 72 x 45	9.0	135.0	80	Y482P1/W410RX
	125	32		95 x 77	75 x 52 / 72 x 45	9.0	161.0	100	Y582P1/W510RX
Non-brake Fixed	75	32		67 x 77	52 x 61.5 / 45 x 56	8.5	107.0	50	Y385P2/W310RX
	100	32		67 x 77	52 x 61.5 / 45 x 56	8.5	135.0	80	Y485P2/W410RX
	125	32		67 x 77	52 x 61.5 / 45 x 56	8.5	161.0	100	Y585P2/W510RX
Non-brake Fixed	100	32		105 x 80	85 x 60 / 75 x 60	10.0	135.0	80	Y448P3/W410RX
	125	32		105 x 80	85 x 60 / 75 x 60	10.0	161.0	100	Y548P3/W510RX

